



Keyline for visual purposes only.



3/11 Wattle Avenue Bongaree QLD

3 2 2

Welcome to your new home on Wattle. This stunning tri-level townhouse in such a highly sought after position is just a hop, skip and a jump (less than 150m) to the sparkling waters and sandy shores of The Pumicestone Passage. Offering the perfect blend of Bribie Island living and modern convenience - now is your chance!

Ground Floor - you will be greeted by the secure, private gated courtyard. This space offers a place to relax and unwind, or maybe start a garden. Inside is the versatile media, study or lounge room. Add the spacious double garage, with not only room for 2 vehicles but additional storage and the first laundry option.

First Floor - the impressive polished timber floors and high ceilings are true features of this open plan living level. The contemporary kitchen with Caesarstone benchtops awaits

Price : Offers Over \$800,000
Building Size : 205 sqm
View : <https://www.kdnorth.com.au/sale/qld/red-cliffe-bribie-caboulture/bongaree/residential/townhouse/8047708>



Julian Ellis
07 3410 7721

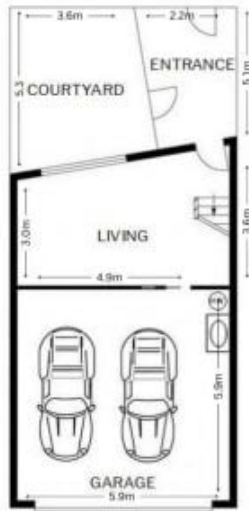

GROUND FLOOR

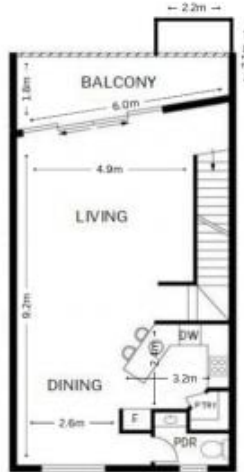

FIRST FLOOR



SECOND FLOOR

DISCLAIMER:

Whilst all details have been carefully prepared and are believed to be correct, no warranty can be given either expressly or implied by the vendors or their agents. Intending purchasers must rely on their own enquiries. Floor plans are indicative only and should not be relied upon as an accurate representation of the final product. Specification may change at anytime. Furniture is not included in the purchase price. Service ducts and structural elements are not shown. The floor plan is for illustrative purposes only should be used as such by any prospective purchaser. Plans not to scale.